

Product card -
**Refrigeration
sandwich panel**

SPW-C CORE^{PIR}

THE POWER OF ROOFS



Product card

Refrigeration sandwich panel

SPW-C CORE^{PIR}



Scan the code
and learn more
about the product!

Sandwich panels are high-performance products that meet the requirements of the modern construction market.

Suitable for the construction of exterior wall claddings and ceilings of cold storage, industrial and public utility buildings.

For the investor, it is a high quality product at a good price. For architects, it offers many possibilities in relation to the design intent. For construction managers, quick and easy installation. For construction supervision, friendly and transparent possibilities to verify the course of the entire process of construction execution from delivery until build acceptance.

Technical information

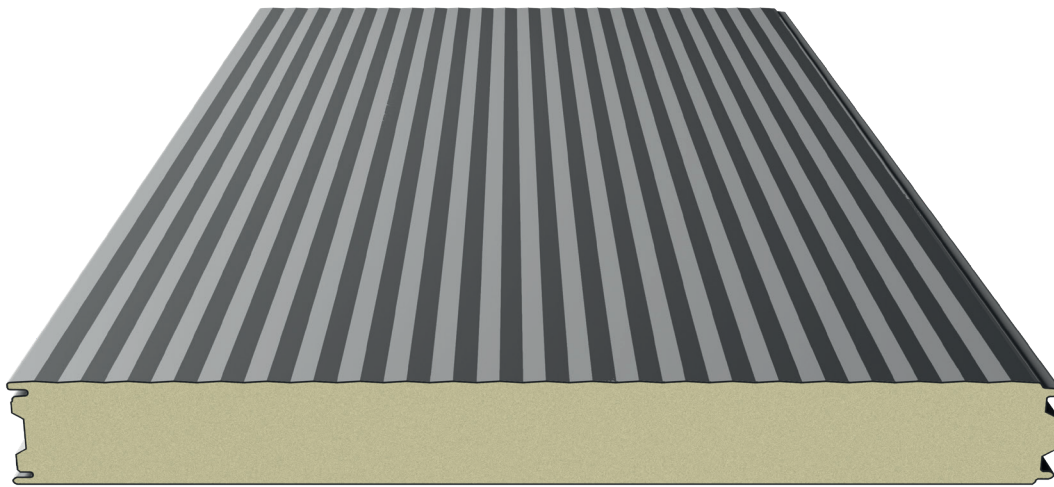

Board cross-section

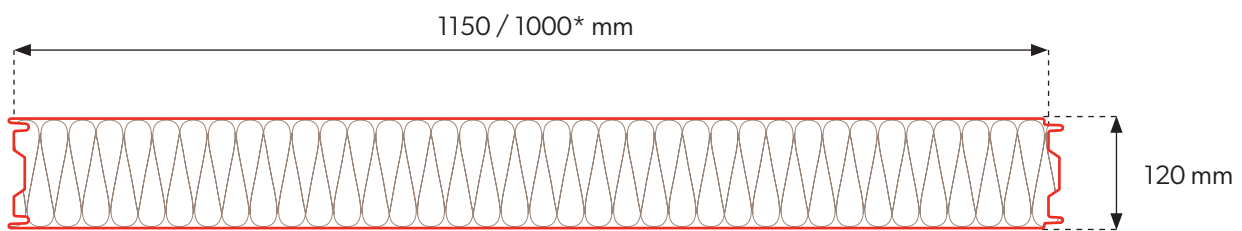

Joining of panels

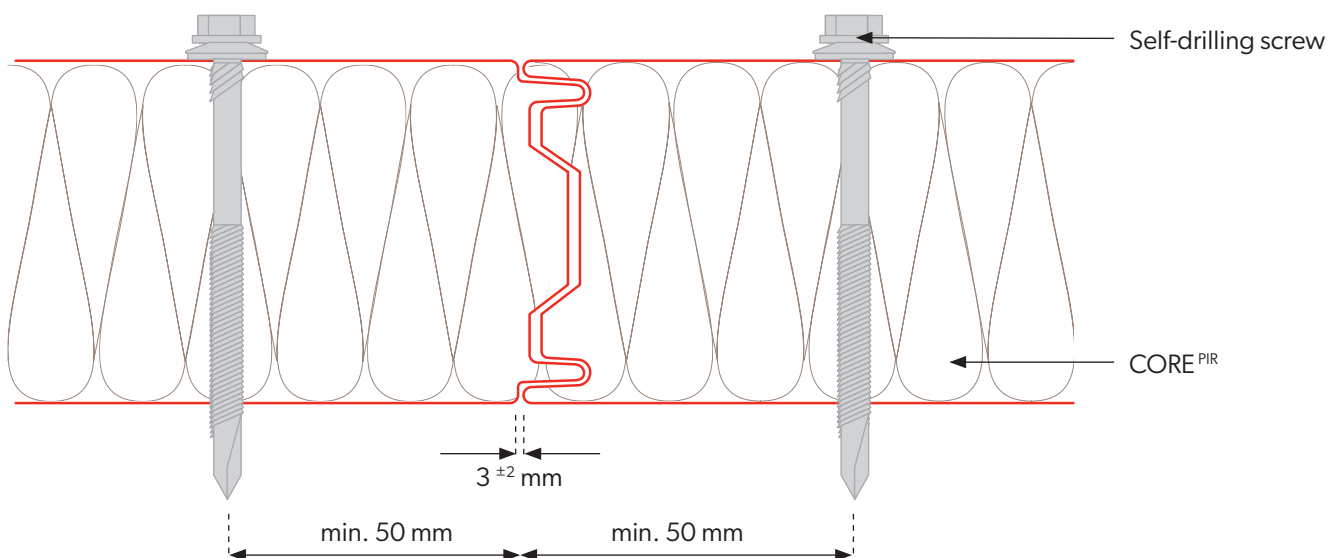

* Module availability is determined individually with the sales department..

Technical information

Core	PIR
Density [kg/m ³]	40 ± 3
PIR panel thickness [mm]	120
Weight [kg/m ²]	11,9
Effective width [mm]	1150, 1000*
Total width [mm]	1171, 1021*
Min. panel length [m]	2,0
Max. panel length [m]	15,0
Outer/inner sheet thickness [mm]	0,4-0,7 / 0,4-0,7
U-value [W/m ² K]	0,18
Fire spread degree	NRO
Type of external / internal profiling	[M], [T], [R], [F] / [M], [T], [F]
External / internal corrosion resistance	C1, C2, C3 (C4 ÷ C5) / A1 (A2 ÷ A5)
Standard coatings	Poliester Interior [INT], Poliester Standard [RAL], HERCULIT [HC], MULTILAYER 40 [MLT]
Special coatings	PVDF, PUR, PVC (P), PVC (F) - FoodSafe
Accessories	fixing system, seals, flashings, rooflight SPR-SKY

Packaging of sandwich panels

Panel thickness [mm]	Modular width [mm]	Number of panels per pack [pcs]	Number of packages on a vehicle [pcs]	Maximum package height [mm]	Package height [mm]	Panel weight [kg/m ²]	Weight of 1 package [kg]	Surface area of panels [m ² /car]**
120	1150	10	4	1300	2600	11,9	1847,5	621,0



* Module availability is agreed individually with the sales department.

** Surface area of panels on car calculated for panel lengths of 13.5 m.

Technical information

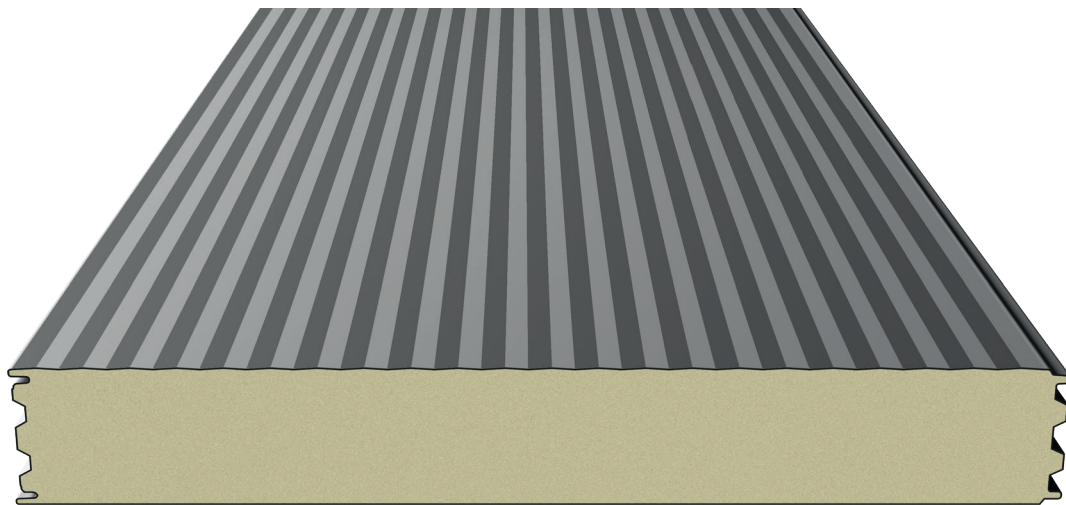

Board cross-section

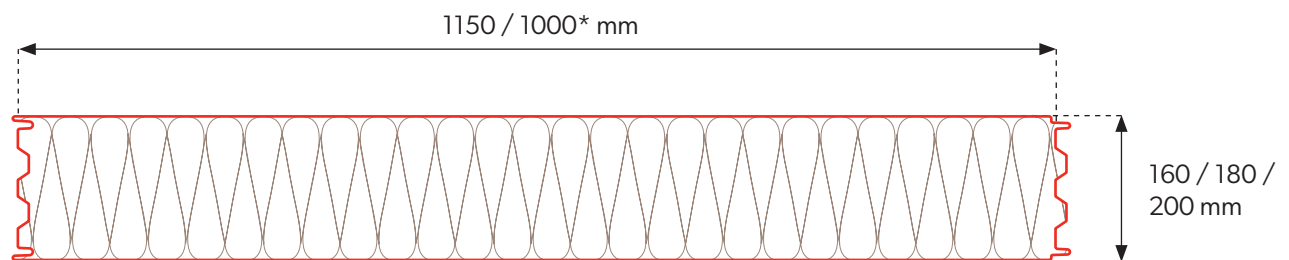

Joining of panels

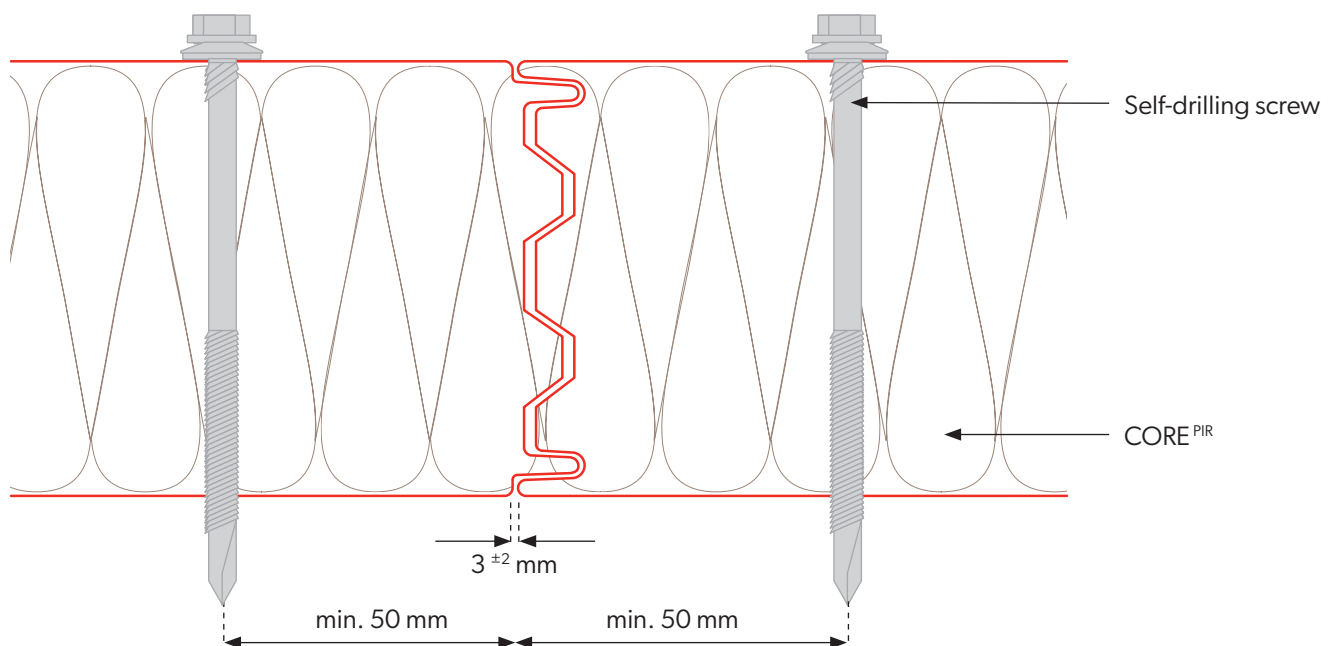

* Module availability is determined individually with the sales department..

Technical information

Core	PIR		
Density [kg/m ³]	40 ± 3		
PIR panel thickness [mm]	160	180	200
Weight [kg/m ²]	13,5	14,3	15,1
Effective width [mm]	1150, 1000*		
Total width [mm]	1171, 1021*		
Min. panel length [m]	2,0		
Max. panel length [m]	15,0		
Outer/inner sheet thickness [mm]	0,4-0,7 / 0,4-0,7		
U-value [W/m ² K]	0,14	0,12	0,11
Fire spread degree	NRO		
Type of external / internal profiling	[M], [T], [R], [F] / [M], [T], [F]		
External / internal corrosion resistance	C1, C2, C3 (C4 ÷ C5) / A1 (A2 ÷ A5)		
Standard coatings	Poliester Interior [INT], Poliester Standard [RAL], HERCULIT [HC], MULTILAYER 40 [MLT]		
Special coatings	PVDF, PUR, PVC (P), PVC (F) - FoodSafe		
Accessories	fixing system, seals, flashings, rooflight SPR-SKY		

Packaging of sandwich panels

Panel thickness [mm]	Modular width [mm]	Number of panels per pack [pcs]	Number of packages on a vehicle [pcs]	Maximum package height [mm]	Package height [mm]	Panel weight [kg/m ²]	Weight of 1 package [kg]	Surface area of panels [m ² /car]**
160	1150	7	4	1220	2440	13,5	1467,1	434,7
180	1150	6	4	1180	2360	14,3	1332,0	372,6
200	1150	6	4	1300	2600	15,1	1406,6	372,6



* Module availability is agreed individually with the sales department.

** Surface area of panels on car calculated for panel lengths of 13.5 m.

External profiling

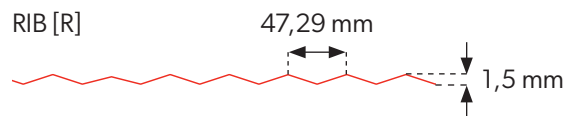
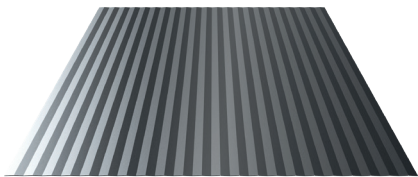
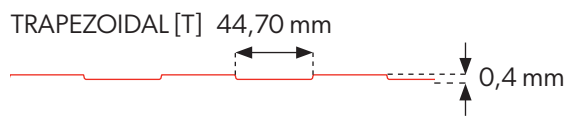
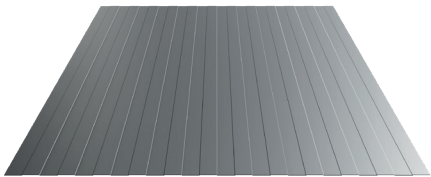
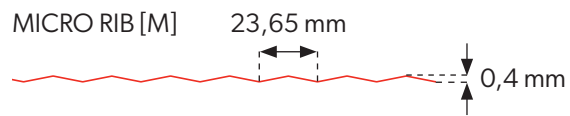
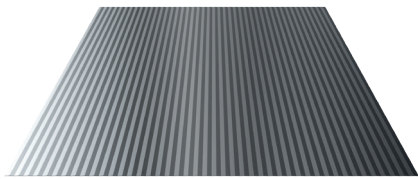

FLAT [F]



Internal profiling

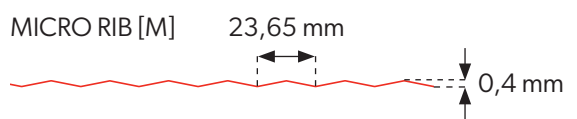
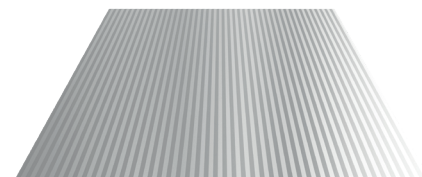
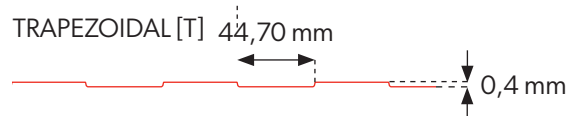
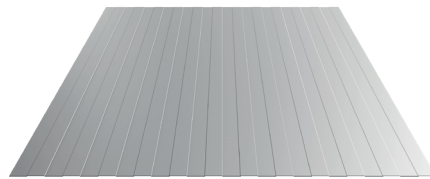

FLAT [F]



Internal and external profiling are available in any configuration.

Coatings and colors

POLIESTER Interior [INT] - Available colors for interior cladding

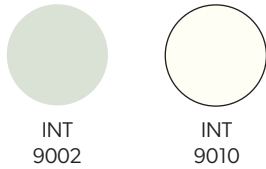

POLIESTER Standard [RAL] - Available colors for exterior cladding

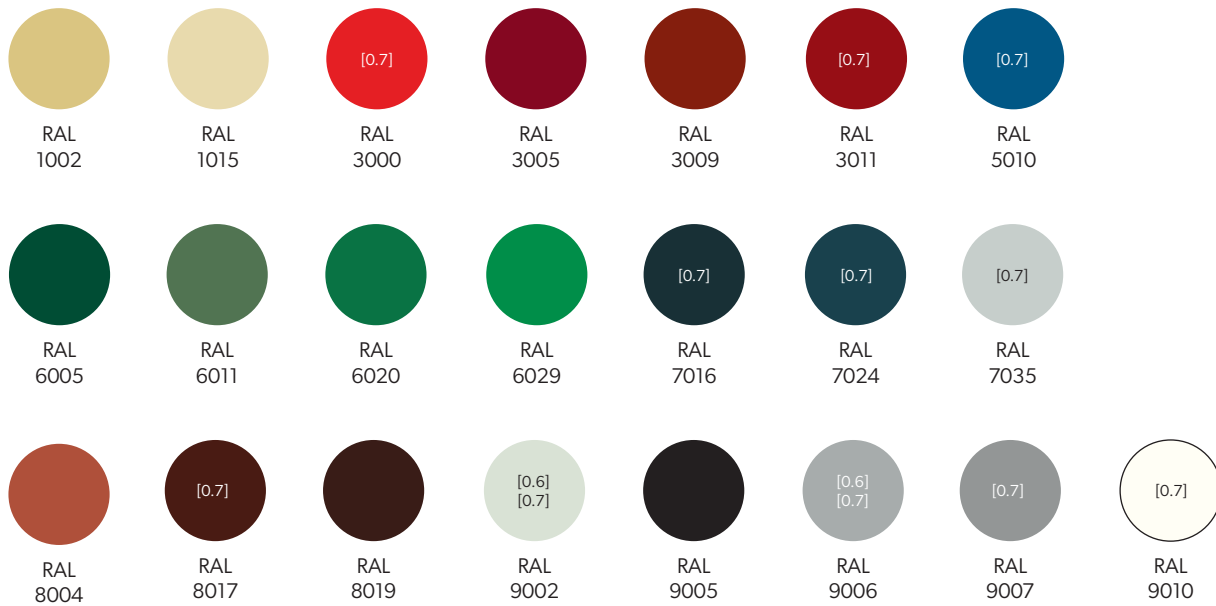

HERCULIT [HC]

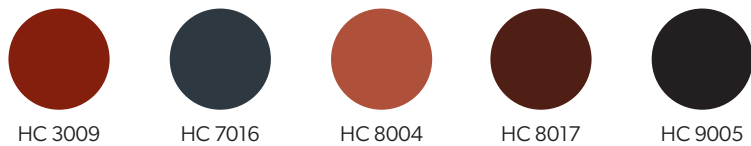

MULTILAYER 40 [MLT] - Available colors for exterior cladding



Printing technology does not allow faithful rendering of colors. Therefore the colors shown are indicative and may differ from actual colors.



In addition, on individual order, non-standard colors and coatings are available, outside the palette shown (PVDF, PUR, PVC (P), PVC (F) - FoodSafe).



Modular roofing tiles
MODULAR SERIES



Compact roofing tiles
COMPACT SERIES



Steel roofing tiles
CLASSIC SERIES



Retro roof tiles
RETRO SERIES



Roof panels
PANEL SERIES



INTEGRATED
PV PANELS



Steel roof gutter system
INGURI



TRAPEZOIDAL
SHEETS



FLAT METAL
SHEETS



FLASHINGS



ACCESORIES



Roof Sandwich
PANELS



Wall Sandwich
PANELS



Facade cladding
SKRIN, LINEA, SINUS



Wall cassette &
PROSYSTEM



Uncoiling and slitting
SERVICES



Flat sheets and cutting
SERVICES



PERFORATION
of sheets

