



Product card - **Wall sandwich panel with concealed fastening**

**SPW-H CORE<sup>WOOL</sup>**

**THE POWER OF ROOFS**



# Product card

## Wall sandwich panel with concealed fastening

**SPW-H CORE<sup>WOOL</sup>**



Scan the code  
and learn more  
about the product!

Sandwich panels are high-performance products that meet the requirements of the modern construction market.

Suitable for the construction of exterior and interior wall claddings and ceilings of industrial or public utility facilities.

For the investor, it is a high quality product at a good price. For architects, it offers many possibilities in relation to the design intent. For construction managers, quick and easy installation. For construction supervision, friendly and transparent possibilities to verify the course of the entire process of construction execution from delivery until build acceptance.

# Technical information

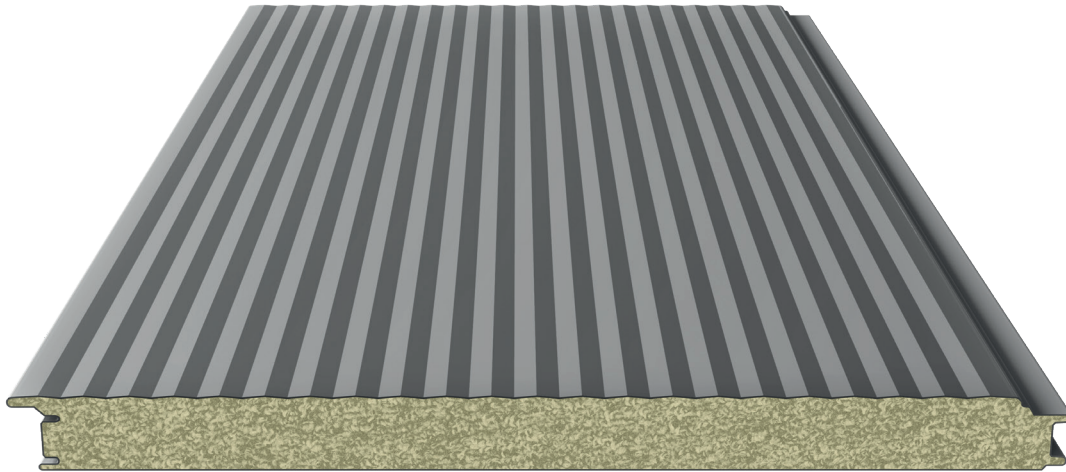

## Board cross-section

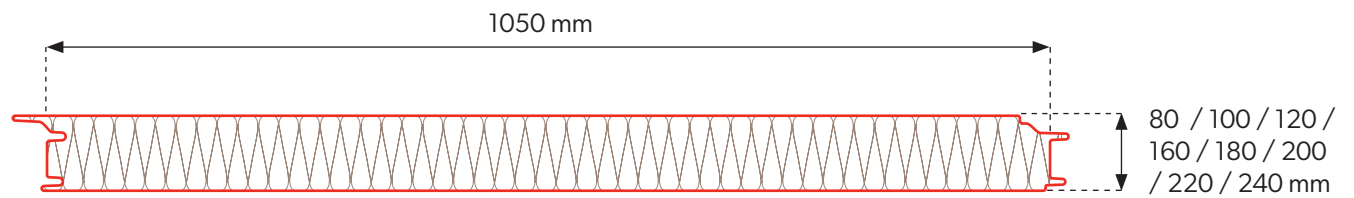

## Joining of panels

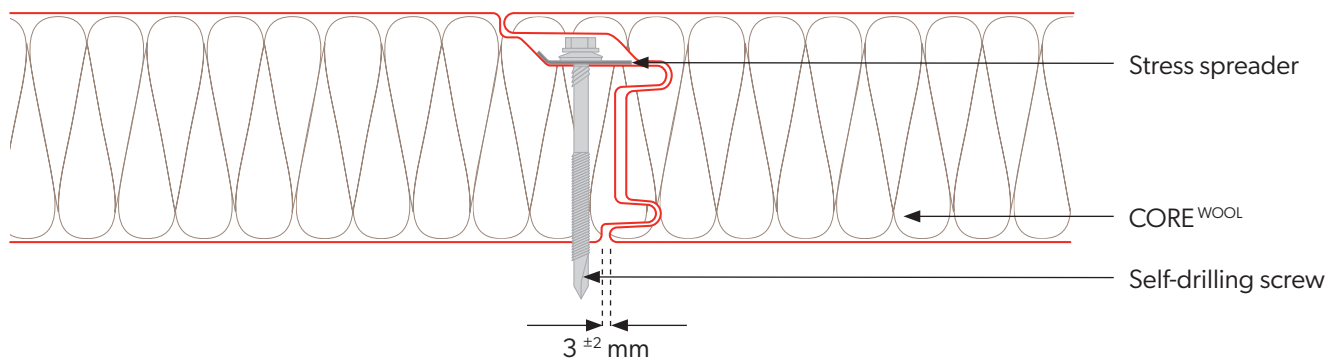

## Technical information

Core	<b>WEŁNA</b>								
Density [kg/m <sup>3</sup> ]	<b>100 ± 10</b>								
WOOL panel thickness [mm]	<b>80</b>	<b>100</b>	<b>120</b>	<b>160</b>	<b>180</b>	<b>200</b>	<b>220</b>	<b>240</b>	
Weight [kg/m <sup>2</sup> ]	<b>16,6</b>	<b>18,6</b>	<b>20,6</b>	<b>24,6</b>	<b>26,6</b>	<b>28,6</b>	<b>30,6</b>	<b>32,6</b>	
Effective width [mm]	<b>1050</b>								
Total width [mm]	<b>1102</b>								
Min. panel length [m]	<b>2,5</b>								
Max. panel length [m]	<b>13,5</b>								
Outer/inner sheet thickness [mm]	<b>0,5-0,7 / 0,5-0,7</b>								
U-value [W/m <sup>2</sup> K]	<b>0,54</b>	<b>0,43</b>	<b>0,36</b>	<b>0,27</b>	<b>0,24</b>	<b>0,22</b>	<b>0,20</b>	<b>0,18</b>	
Fire spread degree	<b>NRO</b>								
Type of external / internal profiling	<b>[M], [T], [R], [F] / [M], [T], [F]</b>								
External / internal corrosion resistance	<b>C1, C2, C3 (C4 ÷ C5) / A1 (A2 ÷ A5)</b>								
Standard coatings	<b>Poliester Interior [INT], Poliester Standard [RAL], HERCULIT [HC], MULTILAYER 40 [MLT]</b>								
Special coatings	<b>PVDF, PUR, PVC (P), PVC (F) - FoodSafe</b>								
Accessories	<b>fixing system, seals, flashings, rooflight</b>								

## Packaging of sandwich panels

Panel thickness [mm]	Modular width [mm]	Number of panels per pack [pcs]	Number of packages on a vehicle [pcs]	Maximum package height [mm]	Package height [mm]	Panel weight [kg/m <sup>2</sup> ]	Weight of 1 package [kg]	Surface area of panels [m <sup>2</sup> /car]**
<b>80</b>	<b>1050</b>	<b>15</b>	<b>4</b>	<b>1300</b>	<b>2600</b>	<b>17,5</b>	<b>2480,6</b>	<b>567,0</b>
<b>100</b>	<b>1050</b>	<b>12</b>	<b>4</b>	<b>1300</b>	<b>2600</b>	<b>19,5</b>	<b>2211,3</b>	<b>453,6</b>
<b>120</b>	<b>1050</b>	<b>10</b>	<b>4</b>	<b>1300</b>	<b>2600</b>	<b>21,5</b>	<b>2031,8</b>	<b>378,0</b>
<b>160</b>	<b>1050</b>	<b>7</b>	<b>4</b>	<b>1220</b>	<b>2440</b>	<b>25,5</b>	<b>1686,8</b>	<b>264,6</b>
<b>180</b>	<b>1050</b>	<b>6</b>	<b>4</b>	<b>1180</b>	<b>2360</b>	<b>27,5</b>	<b>1559,3</b>	<b>226,8</b>
<b>200</b>	<b>1050</b>	<b>6</b>	<b>4</b>	<b>1300</b>	<b>2600</b>	<b>29,5</b>	<b>1672,7</b>	<b>226,8</b>
<b>220</b>	<b>1050</b>	<b>5</b>	<b>4</b>	<b>1200</b>	<b>2400</b>	<b>31,5</b>	<b>1488,4</b>	<b>189,0</b>
<b>240</b>	<b>1050</b>	<b>5</b>	<b>4</b>	<b>1300</b>	<b>2600</b>	<b>33,5</b>	<b>1582,9</b>	<b>189,0</b>



\*\* Surface area of panels on car calculated for panel lengths of 9 m.

## External profiling

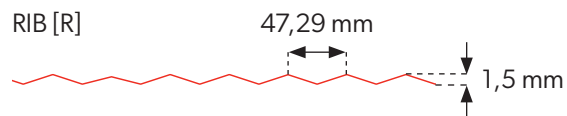
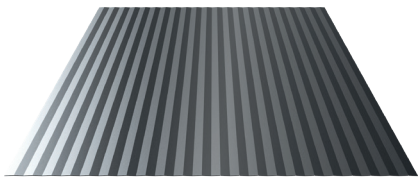
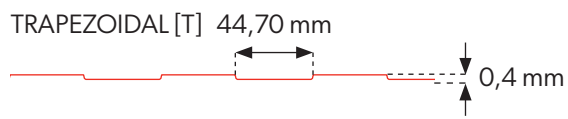
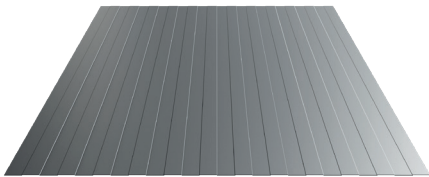
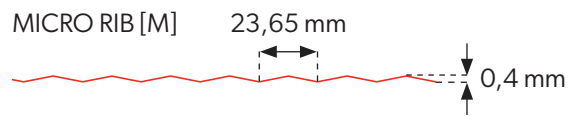
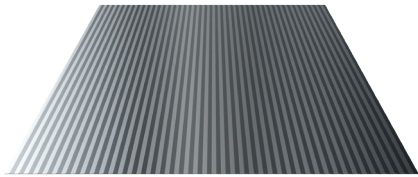

FLAT [F]



## Internal profiling

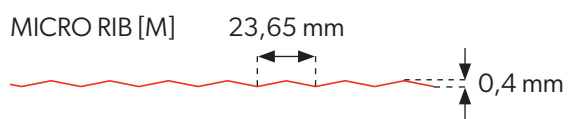
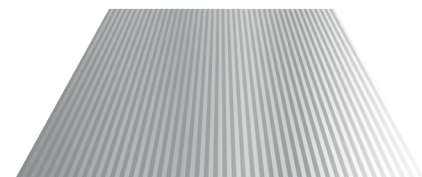
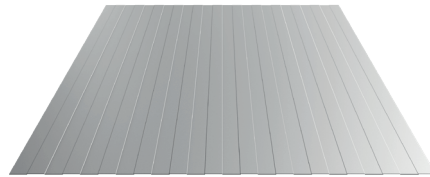

FLAT [F]



Internal and external profiling are available in any configuration.

## Coatings and colors

**POLIESTER Interior [INT]** - Available colors for interior cladding

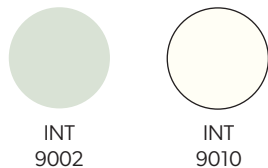

**POLIESTER Standard [RAL]** - Available colors for exterior cladding

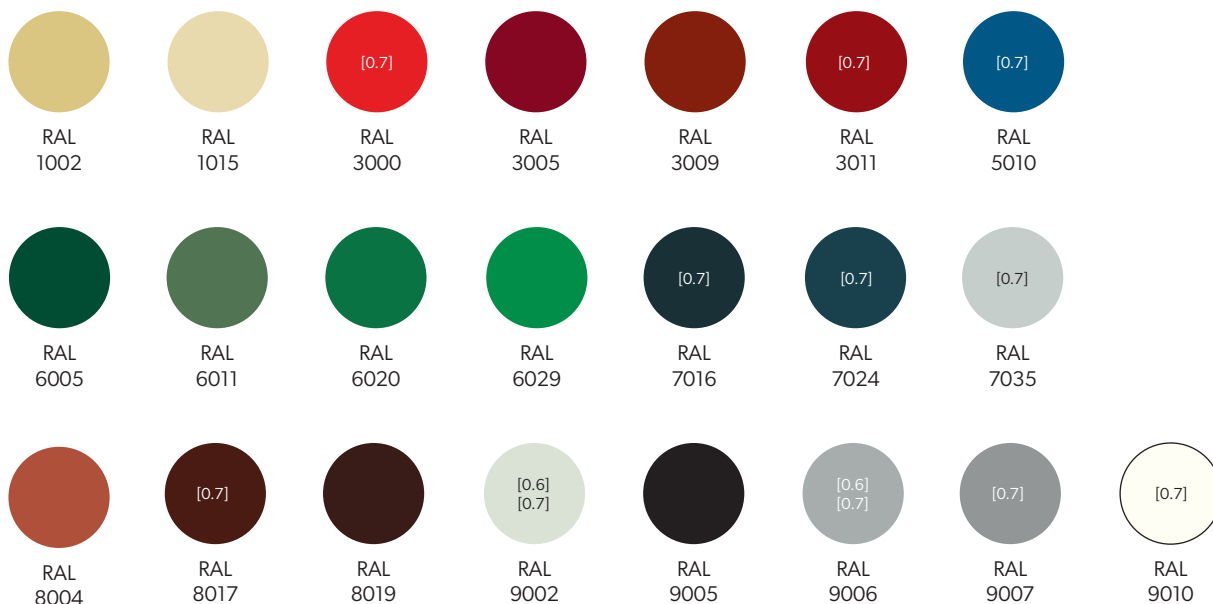

**HERCULIT [HC]**

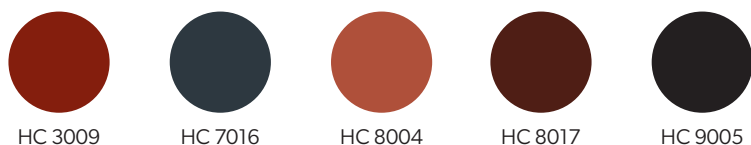

**MULTILAYER 40 [MLT]** - Available colors for exterior cladding



Printing technology does not allow faithful rendering of colors. Therefore the colors shown are indicative and may differ from actual colors.



In addition, on individual order, non-standard colors and coatings are available, outside the palette shown (PVDF, PUR, PVC (P), PVC (F) - FoodSafe).





Modular roofing tiles  
**MODULAR SERIES**



Compact roofing tiles  
**COMPACT SERIES**



Steel roofing tiles  
**CLASSIC SERIES**



Retro roof tiles  
**RETRO SERIES**



Roof panels  
**PANEL SERIES**



INTEGRATED  
**PV PANELS**



Steel roof gutter system  
**INGURI**



**TRAPEZOIDAL  
SHEETS**



**FLAT METAL  
SHEETS**



**FLASHINGS**



**ACCESORIES**



**Roof Sandwich  
PANELS**



**Wall Sandwich  
PANELS**



Facade cladding  
**SKRIN, LINEA, SINUS**



**Wall cassette &  
PROSYSTEM**



Uncoiling and slitting  
**SERVICES**



Flat sheets and cutting  
**SERVICES**



**PERFORATION  
of sheets**

