



Product card - **Wall sandwich panel with visible fastening**

**SPW-S CORE<sup>PIR</sup>**

**THE POWER OF ROOFS**





# Product card

## Wall sandwich panel with visible fastening

**SPW-S CORE<sup>PIR</sup>**



Scan the code  
and learn more  
about the product!

Sandwich panels are high-performance products that meet the requirements of the modern construction market.

Suitable for the construction of exterior and interior wall claddings and ceilings of industrial or public utility facilities.

For the investor, it is a high quality product at a good price. For architects, it offers many possibilities in relation to the design intent. For construction managers, quick and easy installation. For construction supervision, friendly and transparent possibilities to verify the course of the entire process of construction execution from delivery until build acceptance.

# Technical information

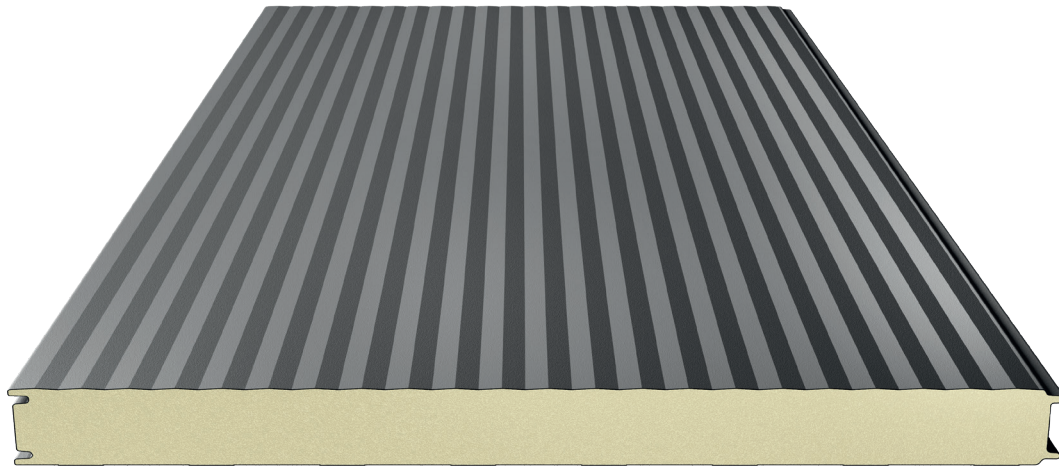

## Board cross-section

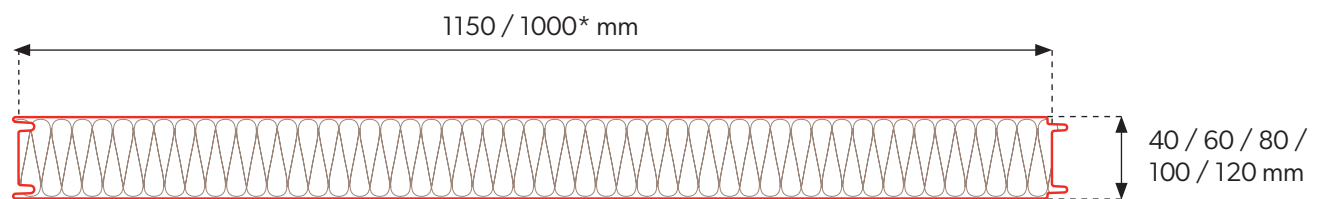

## Joining of panels

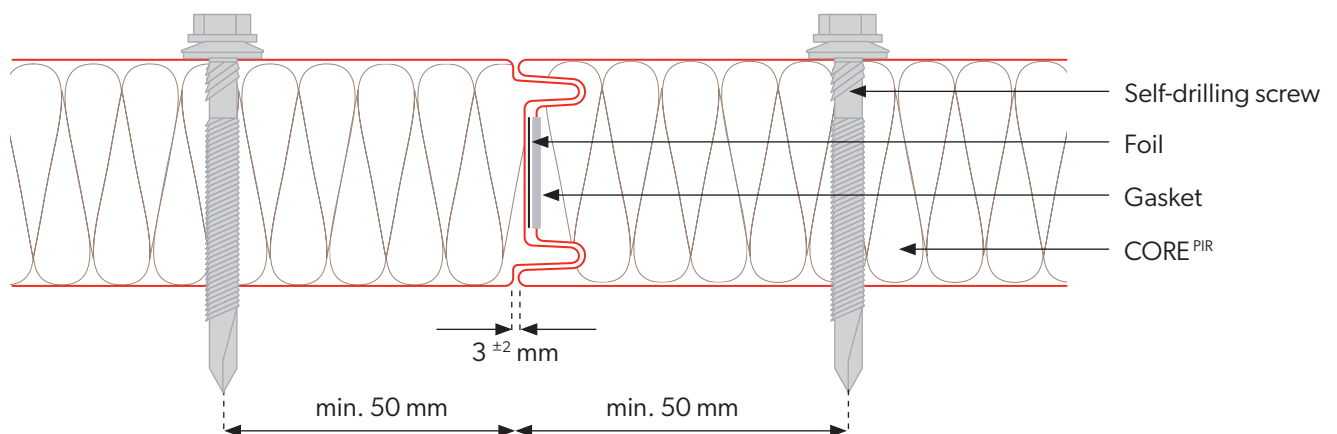

Module availability is determined individually with the sales department.

## Technical information

Core	<b>PIR</b>				
Density [kg/m <sup>3</sup> ]	<b>40 ± 3</b>				
PIR panel thickness [mm]	<b>40</b>	<b>60</b>	<b>80</b>	<b>100</b>	<b>120</b>
Weight [kg/m <sup>2</sup> ]	<b>8,7</b>	<b>9,5</b>	<b>10,3</b>	<b>11,1</b>	<b>11,9</b>
Effective width [mm]	<b>1150, 1000*</b>				
Total width [mm]	<b>1171, 1021*</b>				
Min. panel length [m]	<b>2,5</b>	<b>2,0</b>			
Max. panel length [m]	<b>15,0</b>				
Outer/inner sheet thickness [mm]	<b>0,4-0,7 / 0,4-0,7</b>				
U-value [W/m <sup>2</sup> K]	<b>0,55</b>	<b>0,37</b>	<b>0,28</b>	<b>0,22</b>	<b>0,18</b>
Fire spread degree	<b>NRO</b>				
Fire resistance				<b>EI15</b>	<b>EI30</b>
Type of external / internal profiling	<b>[M], [T], [R], [F] / [M], [T], [F]</b>				
External / internal corrosion resistance	<b>C1, C2, C3 (C4 ÷ C5) / A1 (A2 ÷ A5)</b>				
Standard coatings	<b>Poliester Interior [INT], Poliester Standard [RAL], HERCULIT [HC], MULTILAYER 40 [MLT]</b>				
Special coatings	<b>PVDF, PUR, PVC (P), PVC (F) - FoodSafe</b>				
Accessories	<b>fixing system, seals, flashings, rooflight SPR-SKY</b>				

## Packaging of sandwich panels

Panel thickness [mm]	Modular width [mm]	Number of panels per pack [pcs]	Number of packages on a vehicle [pcs]	Maximum package height [mm]	Package height [mm]	Panel weight [kg/m <sup>2</sup> ]	Weight of 1 package [kg]	Surface area of panels [m <sup>2</sup> /car]**
<b>40</b>	<b>1150</b>	<b>19</b>	<b>6</b>	<b>860</b>	<b>2580</b>	<b>8,7</b>	<b>2566,3</b>	<b>1769,9</b>
<b>60</b>	<b>1150</b>	<b>13</b>	<b>6</b>	<b>880</b>	<b>2640</b>	<b>9,5</b>	<b>1917,3</b>	<b>1211,0</b>
<b>80</b>	<b>1150</b>	<b>15</b>	<b>4</b>	<b>1300</b>	<b>2600</b>	<b>10,3</b>	<b>2398,6</b>	<b>931,5</b>
<b>100</b>	<b>1150</b>	<b>12</b>	<b>4</b>	<b>1300</b>	<b>2600</b>	<b>11,1</b>	<b>2067,9</b>	<b>745,2</b>
<b>120</b>	<b>1150</b>	<b>10</b>	<b>4</b>	<b>1300</b>	<b>2600</b>	<b>11,9</b>	<b>1847,5</b>	<b>621,0</b>



\* Module availability is agreed individually with the sales department.

\*\* Surface area of panels on car calculated for panel lengths of 13.5 m.

## External profiling

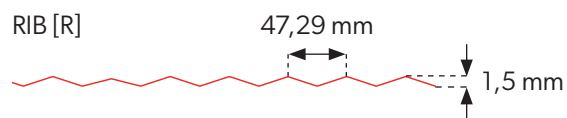
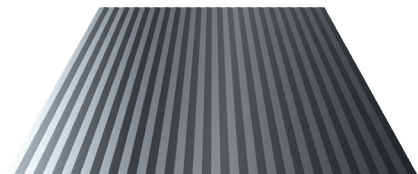
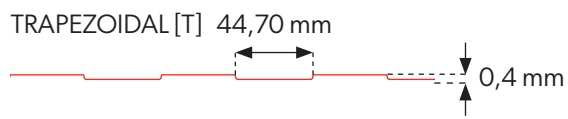
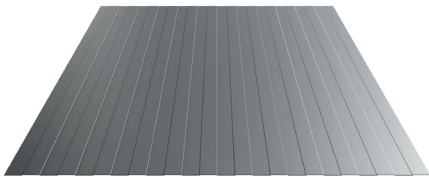
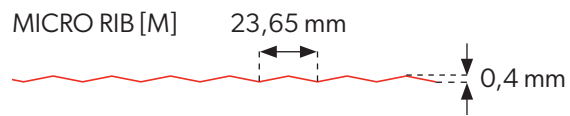
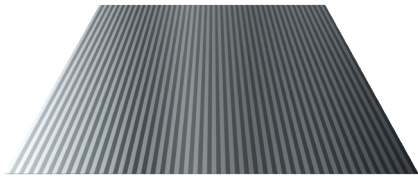

FLAT [F]

## Internal profiling

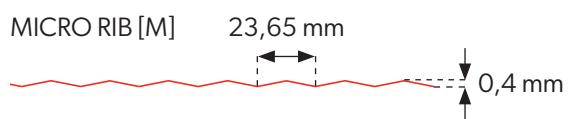
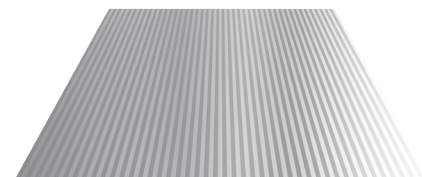
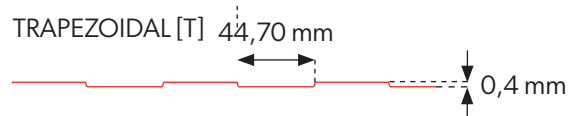
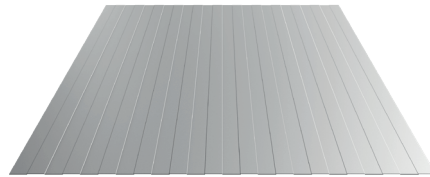

FLAT [F]



Internal and external profiling are available in any configuration.



ATTENTION! Due to the structure of sandwich panels with FLAT [F] profiles, the so-called effect may occur. „waves“ of the sheet metal. This is a natural phenomenon for this type of products. We recommend contacting the technical department to choose the optimal solution.



## Coatings and colors

**POLIESTER Interior [INT]** - Available colors for interior cladding

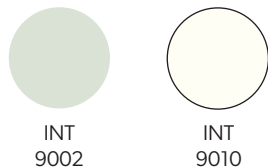

**POLIESTER Standard [RAL]** - Available colors for exterior cladding

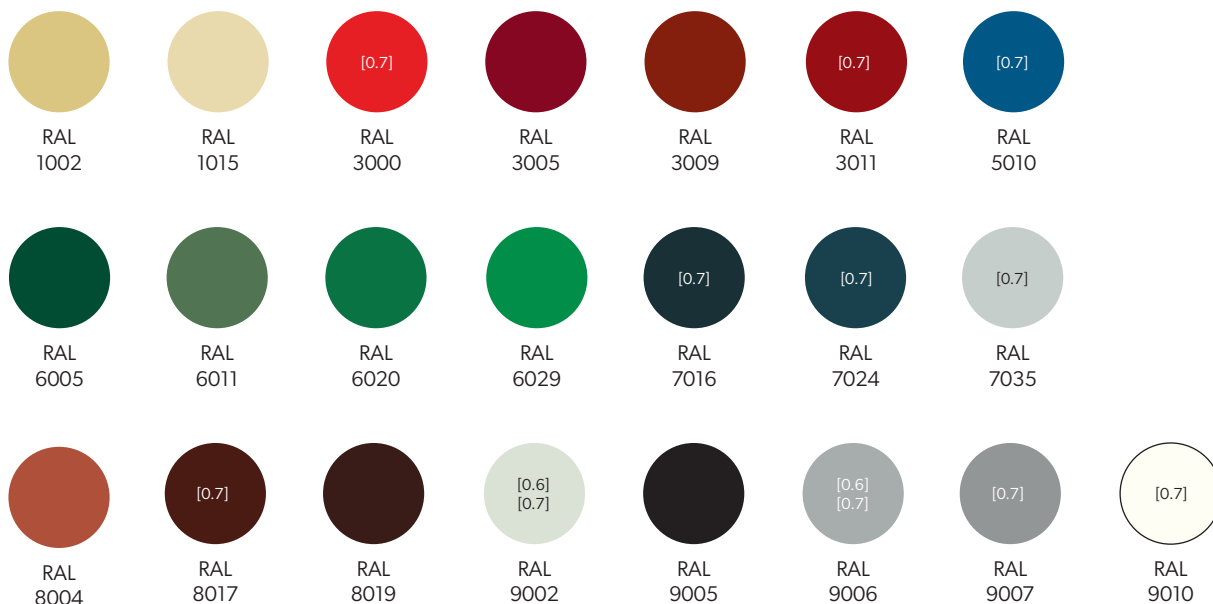

**HERCULIT [HC]**

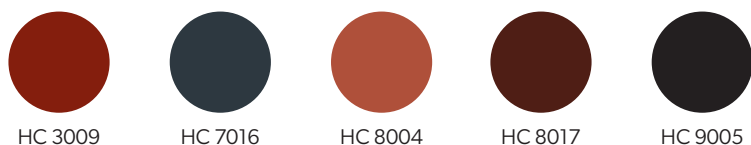

**MULTILAYER 40 [MLT]** - Available colors for exterior cladding



Printing technology does not allow faithful rendering of colors. Therefore the colors shown are indicative and may differ from actual colors.



In addition, on individual order, non-standard colors and coatings are available, outside the palette shown (PVDF, PUR, PVC (P), PVC (F) - FoodSafe).

## Coating parameters

Code	Coating thickness	Corrosion resistance	UV resistance
<b>POLIESTER Interior [INT]</b>	15 µm	RA2	Not applicable
<b>POLIESTER Standard [RAL]</b>	25 µm	RC3	RUV2
<b>HERCULIT [HC]</b>	35 µm	RC4	RUV4
<b>MULTILAYER 40 [MLT]</b>	40 µm	RC3	RUV3

## Notes



Modular roofing tiles  
**MODULAR SERIES**



Compact roofing tiles  
**COMPACT SERIES**



Steel roofing tiles  
**CLASSIC SERIES**



Retro roof tiles  
**RETRO SERIES**



Roof panels  
**PANEL SERIES**



INTEGRATED  
**PV PANELS**



Steel roof gutter system  
**INGURI**



**TRAPEZOIDAL**  
SHEETS



**FLAT METAL**  
SHEETS



**FLASHINGS**



**ACCESORIES**



Roof Sandwich  
PANELS



Wall Sandwich  
PANELS



Facade cladding  
**SKRIN, LINEA, SINUS**



Wall cassette &  
**PROSYSTEM**



Uncoiling and slitting  
**SERVICES**



Flat sheets and cutting  
**SERVICES**



**PERFORATION**  
of sheets

