



Product card - **Wall sandwich panel with visible fastening**

SPW-S CORE^{WOOL}

THE POWER OF ROOFS



Product card

Wall sandwich panel with visible fastening

SPW-S CORE^{WOOL}



Scan the code
and learn more
about the product!

Sandwich panels are high-performance products that meet the requirements of the modern construction market.

Suitable for the construction of exterior and interior wall claddings and ceilings of industrial or public utility facilities.

For the investor, it is a high quality product at a good price. For architects, it offers many possibilities in relation to the design intent. For construction managers, quick and easy installation. For construction supervision, friendly and transparent possibilities to verify the course of the entire process of construction execution from delivery until build acceptance.

Technical information

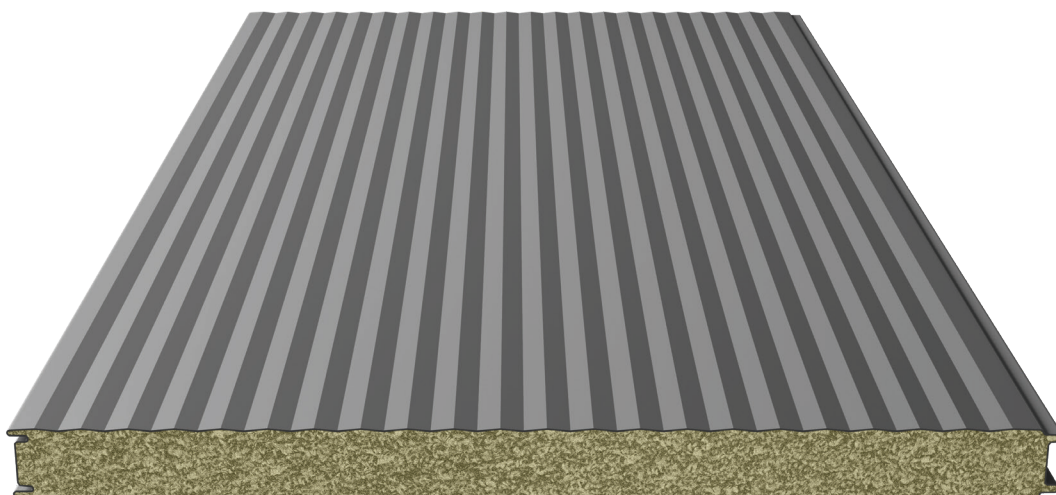

Board cross-section

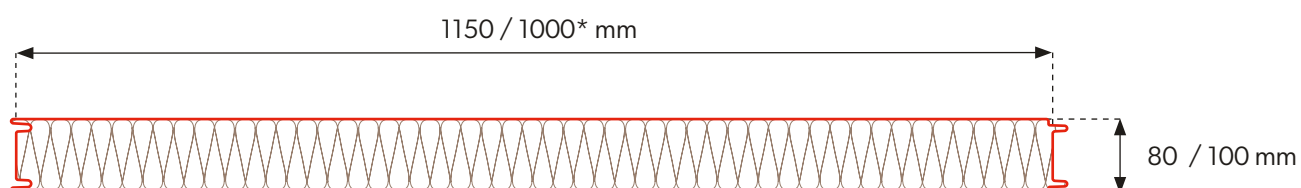

Joining of panels

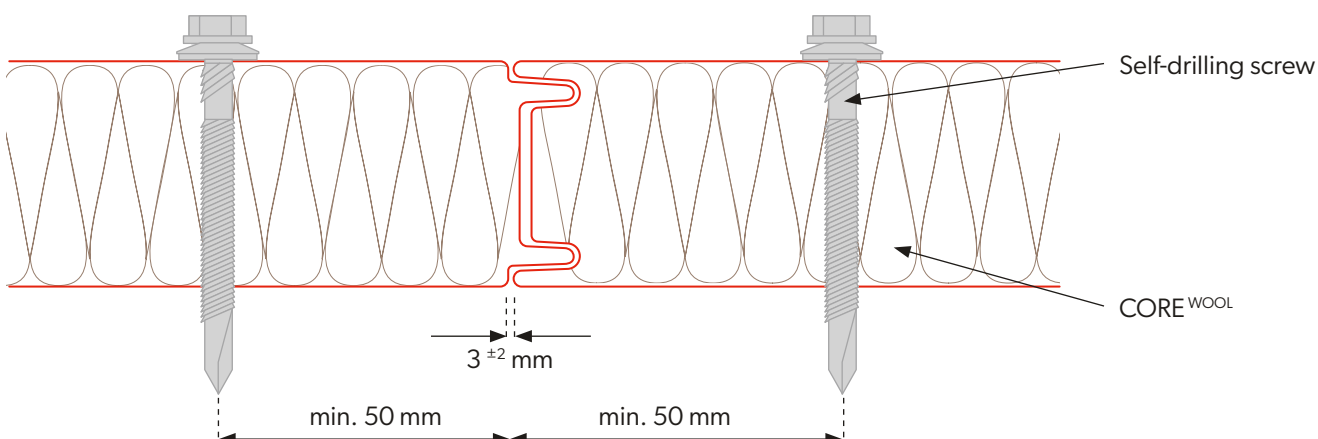

* Module availability is determined individually with the sales department..

Technical information

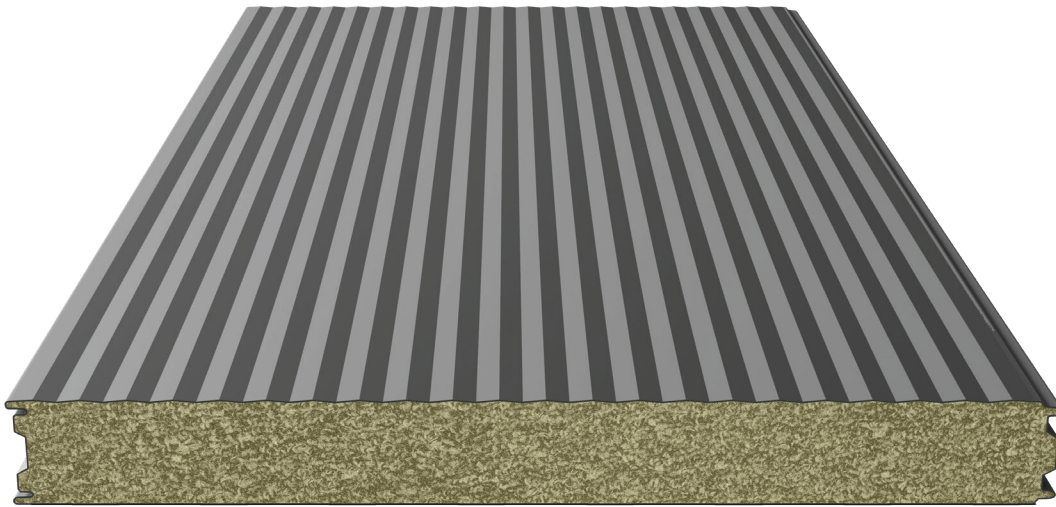

Board cross-section

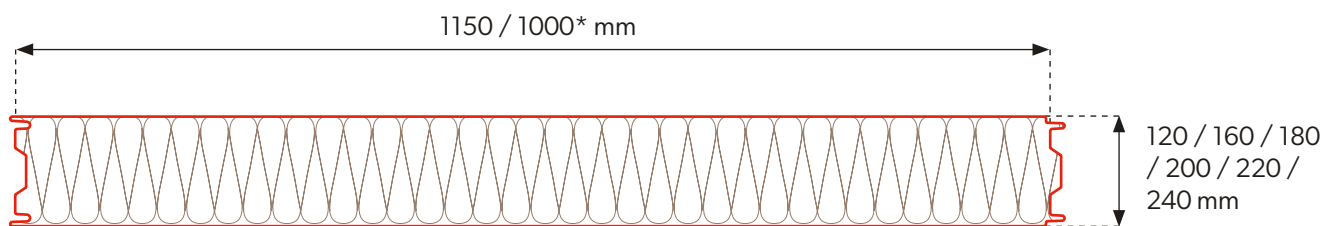

Joining of panels

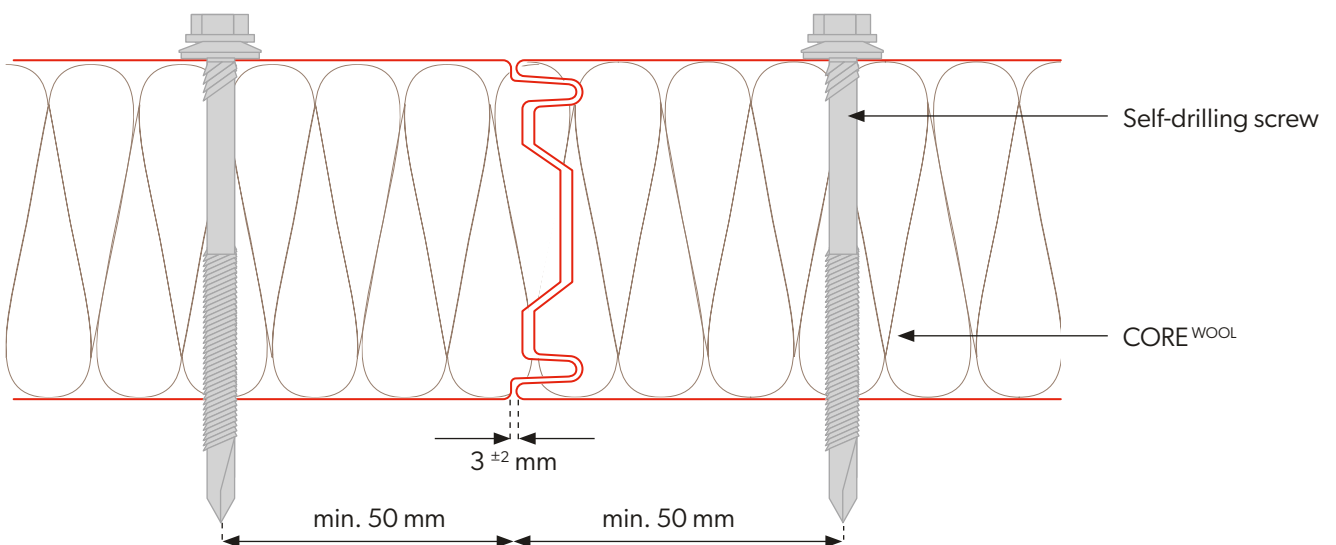

* Module availability is determined individually with the sales department..

Technical information

Core	WOOL							
Density [kg/m ³]	100 ± 10							
PIR panel thickness [mm]	80	100	120	160	180	200	220	240
Weight [kg/m ²]	17,50	19,50	21,50	25,50	27,50	29,50	31,50	33,50
Effective width [mm]	1150, 1000*							
Total width [mm]	1171, 1021*							
Min. panel length [mb]	2,5							
Max. panel length [mb]	13,5							
Outer/inner sheet thickness [mm]	0,5-0,7 / 0,5-0,7							
U-factor [W/m ² K].	0,54	0,43	0,36	0,27	0,24	0,22	0,20	0,18
Reaction to fire	A1							
Wall resistance to external fire	EI120	EI180	EI240	EI240	EI240	EI240	EI240	EI240
Type of profiling ext. / int.	[R], [M], [T], [F] / [M], [T], [F]							
Corrosion resistance ext. / ext.	C1, C2, C3 (C4 ÷ C5) / A1 (A2 ÷ A5)							
Standard coatings	Poliester Interior [INT], Poliester Standard [RAL], HERCULIT [HC], MULTILAYER 40 [MLT]							
Special coatings	PVDF, PUR, PVC (P), PVC (F) - FoodSafe							
Accessories	Fastening system, gaskets, flashings, lighting profiles							

Packaging of sandwich panels

Panel thickness [mm]	Modular width [mm]	Quantity of panels in a package	Quantity of packages per vehicle	Package height [mm]	Package weight [kg]	Maximum loading length [m]	Quantity of panels per vehicle [m ²]
80	1150	14	4	1220	2440	12	773
100	1150	11	4	1200	2400	12	607
120	1150	9	4	1180	2360	12	497
160	1150	7	4	1220	2440	12	386
200	1150	5	4	1100	2200	12	276
220	1150	5	4	1200	2400	12	276
240	1150	4	4	1060	2120	12	221



Module availability is determined individually with the sales department.

External profiling

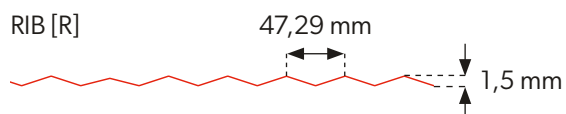
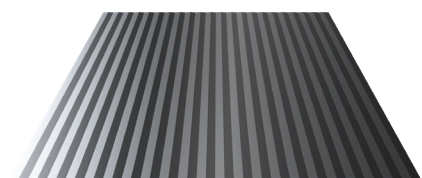
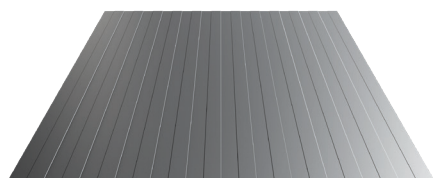
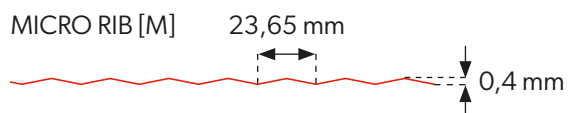
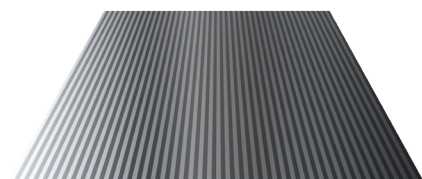

FLAT [F]



Internal profiling

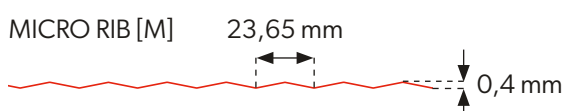
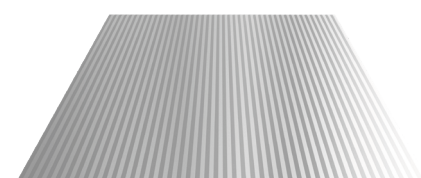
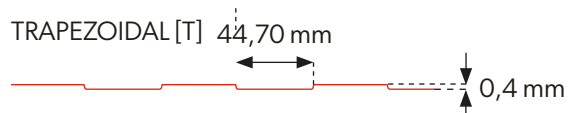
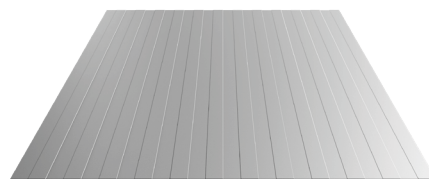

FLAT [F]



Internal and external profiling are available in any configuration.

Coatings and colors

POLIELSTER Interior [INT] - Available colors for interior cladding



INT
9002

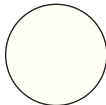

INT
9010

POLIELSTER Standard [RAL] - Available colors for exterior cladding



RAL
1002



RAL
1015



RAL
3000



RAL
3005



RAL
3009



RAL
3011



RAL
5010



RAL
6005



RAL
6011



RAL
6020



RAL
6029



RAL
7016



RAL
7024



RAL
7035



RAL
8004



RAL
8017



RAL
8019



RAL
9002



RAL
9005



RAL
9006



RAL
9007



RAL
9010

HERCULIT [HC]



HC 3009



HC 7016



HC 8004



HC 8017



HC 9005

MULTILAYER 40 [MLT] - Available colors for exterior cladding



SL252
Winchester



SL55
Venge



SL59
Dark Oak



SL65
Golden
Oak



Printing technology does not allow faithful rendering of colors. Therefore the colors shown are indicative and may differ from actual colors.



In addition, on individual order, non-standard colors and coatings are available, outside the palette shown (PVDF, PUR, PVC (P), PVC (F) - FoodSafe).

Coating parameters

Code	Coating thickness	Corrosion resistance	UV resistance
POLYESTER Interior [INT]	15 µm	RA2	Not applicable
POLYESTER Standard [RAL]	25 µm	RC3	RUV2
HERCULIT [HC]	35 µm	RC4	RUV4
MULTILAYER 40 [MLT]	40 µm	RC3	RUV3

Notes



Modular roofing tiles
MODULAR SERIES



Compact roofing tiles
COMPACT SERIES



Steel roofing tiles
CLASSIC SERIES



Retro roof tiles
RETRO SERIES



Roof panels
PANEL SERIES



INTEGRATED
PV PANELS



Steel roof gutter system
INGURI



TRAPEZOIDAL
SHEETS



FLAT METAL
SHEETS



FLASHINGS



ACCESORIES



Roof Sandwich
PANELS



Wall Sandwich
PANELS



Facade cladding
SKRIN, LINEA, SINUS



Wall cassette &
PROSYSTEM



Uncoiling and slitting
SERVICES



Flat sheets and cutting
SERVICES



PERFORATION
of sheets

